

THIS COPY IS PROVIDED ON A RESTRICTED BASIS AND IS NOT TO BE USED IN ANY WAY DETRIMENTAL TO THE INTERESTS OF PANDUIT CORP.

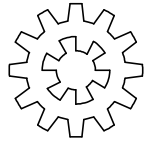

GROUNDING WASHER (QTY. 1)



#10-24 HEX NUT (QTY. 1)

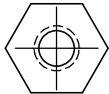

#10-32 HEX NUT (QTY. 1)



#10 SPLIT LOCK WASHER (QTY. 1)



ESD STICKER (QTY. 1)

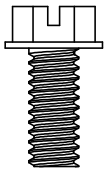

#12-24 SCREW (QTY. 4)

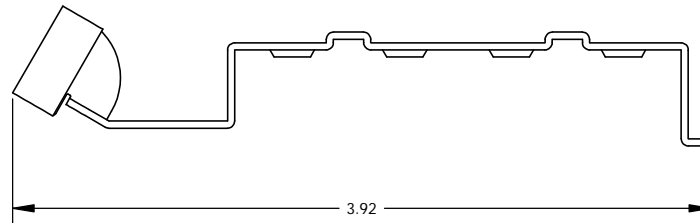
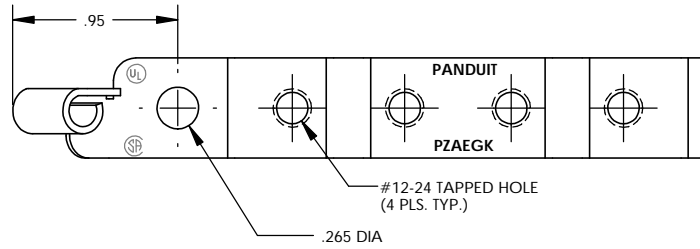

GROUND BRACKET (QTY. 1)

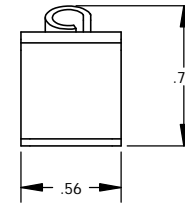

NOTES:

- ENCLOSURE GROUNDING KIT
PART NUMBER: PZAEGK
- PACKAGING: 1 KIT PER BAG
- ALL COMPONENTS THAT MAKE UP THIS KIT
ARE RoHS COMPLIANT.



LISTED
GROUNDING AND BONDING EQUIPMENT



CERTIFIED

C41682_00

PANDUIT CORP. TINLEY PARK, ILLINOIS

ENCLOSURE GROUNDING KIT
(PZAEGK)
CUSTOMER DRAWING

UNLESS OTHERWISE SPECIFIED
DIMENSIONAL TOLERANCES ARE:
(X) ± (XXX) ±
(.XX) ± ANGLES ±

UNLESS OTHERWISE SPECIFIED,
ALL DIMENSIONS ARE GIVEN IN
INCHES, THIRD ANGLE PROJECTION

DRAWN BY JHNU MAT'L:

SCALE NONE

DATE 11/06

DRAWING NO / CAD FILE

DWG

REV	DATE	BY	CHK	DESCRIPTION	ECN	PM	CUST	CHK'D
00	11/06	JHNU	RGB	DRAWING RELEASED	PC00599			

C41682

B
SIZE