

RCM20-01 DC RESIDUAL CURRENT MONITOR

The RCM20-01 is a residual current monitor intended for the detection of DC residual currents in 50Hz/60Hz AC installations.

The RCM20-01 is primarily intended for use in Mode 3 Electric Vehicle charging stations, to disconnect the supply to the Electric Vehicle under DC residual fault current condition.

The RCM20-01 may be used to detect DC residual currents in DC, single phase or multiphase installations.

The RCM20-01 is a compact solution designed to be panel mounted. It has a JST connector for easy installation.

This product is fully compliant with the detection requirements of IEC62955.

MAIN FEATURES

- Operates from a 12-24V DC supply
- External Test Facility
- JST XH 2.5mm Pitch Connector JST:B4B-XH-A (LF)(SN)
- “Fault” signal output
- For use with single or 3 phase loads
- ROHS compliant
- Complies with the DC detection requirements of IEC62955 (Mode 3)
- 3000A Surge Current Withstand
- 20mm Aperture



Order Code: 90122

SEE ALSO

RCM20-03	6mA DC/30mA AC Detection to IEC62752, 20mm CT Aperture
RCM20-04	56mA DC/20mA AC Detection to UL2231, 20mm CT Aperture
RCM14-01	6mA DC Detection to IEC62955, 14mm CT Aperture

Supply Conditions

The RCM20-01 is intended for operation with a supply voltage of 12-24V DC +/- 10%. Performance may be compromised if the supply voltage is outside these limits.

Fault Operation & Auto Reset

When a residual fault current that exceeds the rated DC level is detected, the RCM20-01 Output pin will switch to the "Fault" state within the specified response times. The Output pin will Auto-Reset when the fault is removed.

PIN OUT	
Pin 1	0V
Pin 2	VCC
Pin 3	External Test Facility
Pin 4	Fault Signal Output (Active High Open Drain)

See Application Sheet WA-AS-017 for Connection Diagram

TECHNICAL DATA	
Relevant Product Standard	IEC 62955
Rated Residual Operating Current - (I _{Δn})	6mA DC
Rated Non-operating Residual Current Limit - (I _{Δno})	3mA DC
Response Time to residual current fault (time between appearance of fault to output going high)	According to IEC 62955
DC Supply Voltage (V _{cc}): Supply Current (no fault present @24V) Supply Current (fault current >200mA @24V)	12-24V DC ± 10% 4.2mA 13mA
Test Current limit for 12 – 24V externally applied to Test Input	0.8mA DC Maximum
Fault Signal Output Drain Current Pull up Voltage	Active High Open Drain 100mA Maximum +26.4V DC Maximum
Environmental Operating Conditions Absolute Temperature	85°C to -40°C
Weight	37g

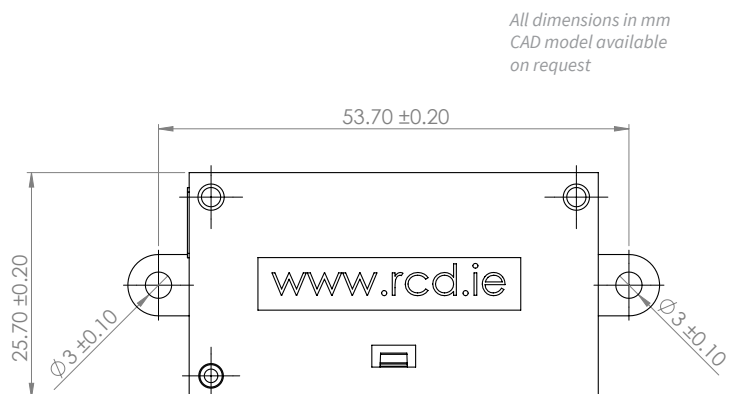
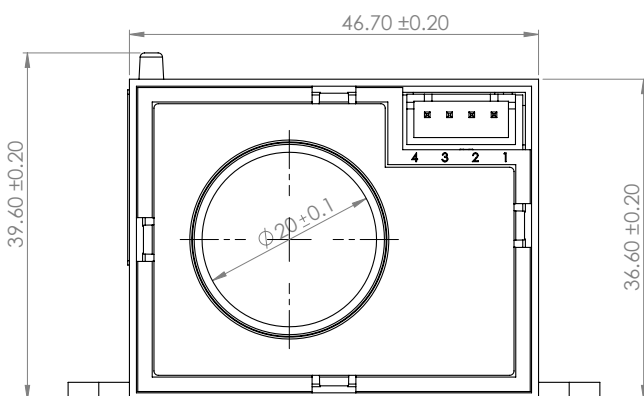

All dimensions in mm
CAD model available
on request

Disclaimer: Whilst every effort has been made to ensure the technical accuracy of this document, changes may be made to the document without notice based on information received by WA which necessitate such changes. WA ensures compliance of its products/technology with Product Standards relevant to the WA technology. However, the User of our products/technology has the sole responsibility to ensure that any Product that they produce which uses WA technology complies with the relevant Product Standards and Installation Rules as applicable to the end Product using the WA technology.