

X-LRT-EC Series Datasheet



- 100, 250, 500, 750, 1000, 1500 mm travel
- Up to 700 mm/s speed and up to 1200 N thrust
- 300 kg load capacity
- High cantilever stiffness
- Ball screw and lead screw configurations
- Includes stainless steel dust covers
- Optional integrated power-off brake for vertical applications
- Built-in, 400 CPR, motor encoder provides slip/stall detection and recovery
- Built-in controller; daisy-chains with other Zaber products

X-LRT-EC Series Overview

Zaber's X-LRT-EC Series devices are computer-controlled, motorized linear stages with high torsional stiffness, load capacity, and long lifetime. They have low pitch, roll, yaw, and runout. A flexible stainless steel dust cover prevents the ingress of small objects. They are stand-alone units requiring only a standard 24 V or 48 V power supply. The built-in motor encoder allows closed-loop operation and slip/stall recovery features. An indexed knob provides convenient manual control for versatile operation even without a computer. An optional power-off brake is available to enable vertical applications with backdrivable screws.

These stages connect to the RS-232 port or USB port of any computer, and they can be daisy-chained with any other Zaber products. The daisy-chain also shares power, making it possible for multiple X-Series products to share a single power supply. Convenient locking, 4-pin, M8

connectors on the unit allow for secure connection between units.

Like all of Zaber's products, the X-LRT-EC Series is designed to be 'plug and play' and very easy to set up and operate. These stages can easily be mounted in XY or XYZ configurations with an angle bracket.

For more information visit: <https://www.zaber.com/products/linear-stages/X-LRT-EC>

X-LRT-EC Series Part Numbering & Options

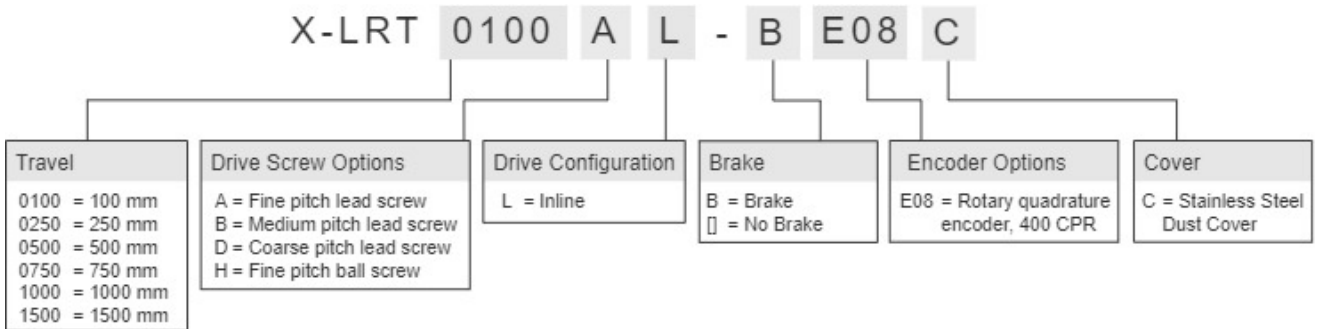

X-LRT-EC Series Drawings

ZABER

X-LRT-EC Motorized Stage
dimensions in mm

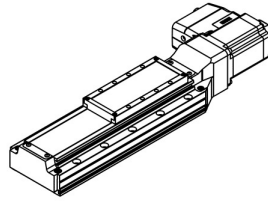

Model Number*	Travel	A	B
X-LRT0100xL-EC	100	417.8	245
X-LRT0250xL-EC	250	567.8	395
X-LRT0500xL-EC	500	817.8	645
X-LRT0750xL-EC	750	1067.8	895
X-LRT1000xL-EC	1000	1317.8	1145
X-LRT1500xL-EC	1500	1817.8	1645

*See product page for complete list of available models at www.zaber.com

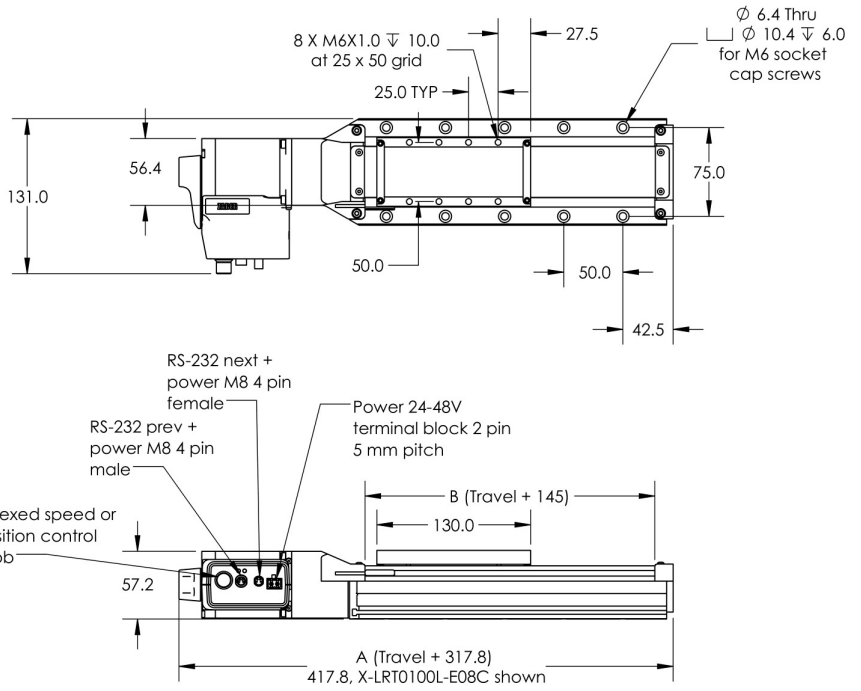
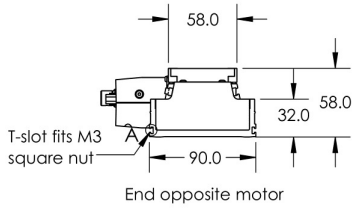
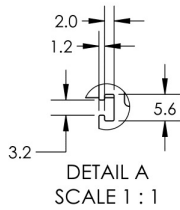

DWG 3387 R01

ZABER

X-LRT-BEC
dimensions in mm

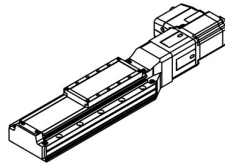

Model Number*	Travel	A	B
X-LRT0100-BE08C	100.0	473.8	245.0
X-LRT0250-BE08C	250.0	623.8	395.0
X-LRT0500-BE08C	500.0	873.8	645.0
X-LRT0750-BE08C	750.0	1123.8	895.0
X-LRT1000-BE08C	1000.0	1373.8	1145.0
X-LRT1500-BE08C	1500.0	1873.8	1645.0

*See product page for complete list of available models at www.zaber.com

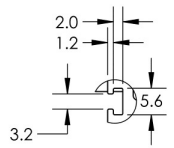

DETAIL A
SCALE 1 : 1

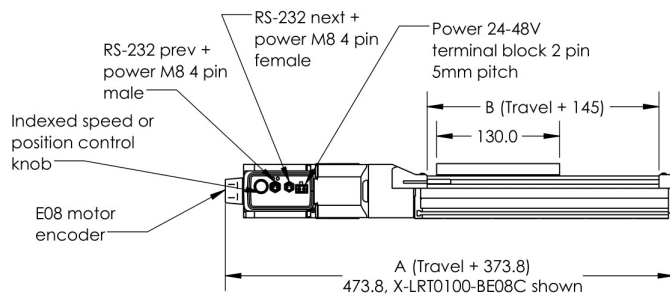
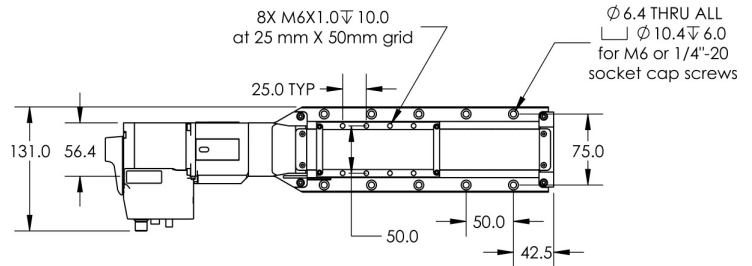
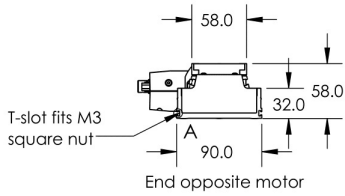

DWG 4197 R01A

X-LRT-EC Series Specifications

Built-in Controller	
Encoder Resolution	400 CPR (1600 states/rev)
Encoder Type	Rotary quadrature encoder
Communication Interface	RS-232
Communication Protocol	Zaber ASCII
Data Cable Connection	Locking 4-pin M8
Maximum Centered Load	2940 N (659.3 lb)
Maximum Cantilever Load	120 N-m (88.6 ft-lb)
Guide Type	Recirculating Ball Linear Guide
Vertical Runout	< 10 μm (< 0.000394")
Horizontal Runout	< 50 μm (< 0.001968")
Pitch	0.015° (0.262 mrad)
Roll	0.02° (0.349 mrad)
Yaw	0.03° (0.523 mrad)
Stiffness in Pitch	1400 N-m/° (12 $\mu\text{rad/N-m}$)
Stiffness in Roll	700 N-m/° (25 $\mu\text{rad/N-m}$)
Stiffness in Yaw	1200 N-m/° (15 $\mu\text{rad/N-m}$)
Power Supply	24-48 VDC
Power Plug	2-pin screw terminal
Maximum Current Draw	3600 mA
Motor Steps Per Rev	200
Motor Type	Stepper (2 phase)
Motor Rated Current	4200 mA/phase
Inductance	2 mH/phase
Default Resolution	1/64 of a step
Limit or Home Sensing	Magnetic home sensor
Manual Control	Indexed knob with push switch
Axes of Motion	1
LED Indicators	Yes
Operating Temperature Range	0 to 50 °C
RoHS Compliant	Yes

Built-in Controller	
CE Compliant	Yes
Vacuum Compatible	No

Part Number	Microstep Size (Default Resolution)	Travel Range	Accuracy (unidirectional)	Repeatability
X-LRT0100AL-E08C	0.124023438 µm	100 mm (3.937")	25 µm (0.000984")	< 4 µm (< 0.000157")
X-LRT0100BL-E08C	0.49609375 µm	100 mm (3.937")	25 µm (0.000984")	< 4 µm (< 0.000157")
X-LRT0100BL-BE08C	0.49609375 µm	100 mm (3.937")	25 µm (0.000984")	< 4 µm (< 0.000157")
X-LRT0100DL-E08C	1.984375 µm	100 mm (3.937")	25 µm (0.000984")	< 8 µm (< 0.000315")
X-LRT0100DL-BE08C	1.984375 µm	100 mm (3.937")	25 µm (0.000984")	< 8 µm (< 0.000315")
X-LRT0100HL-E08C	0.390625 µm	100 mm (3.937")	45 µm (0.001772")	< 4 µm (< 0.000157")
X-LRT0100HL-BE08C	0.390625 µm	100 mm (3.937")	45 µm (0.001772")	< 4 µm (< 0.000157")
X-LRT0250AL-E08C	0.124023438 µm	250 mm (9.843")	63 µm (0.002480")	< 4 µm (< 0.000157")
X-LRT0250BL-E08C	0.49609375 µm	250 mm (9.843")	63 µm (0.002480")	< 4 µm (< 0.000157")
X-LRT0250BL-BE08C	0.49609375 µm	250 mm (9.843")	63 µm (0.002480")	< 4 µm (< 0.000157")
X-LRT0250DL-E08C	1.984375 µm	250 mm (9.843")	63 µm (0.002480")	< 8 µm (< 0.000315")
X-LRT0250DL-BE08C	1.984375 µm	250 mm (9.843")	63 µm (0.002480")	< 8 µm (< 0.000315")
X-LRT0250HL-E08C	0.390625 µm	250 mm (9.843")	113 µm (0.004449")	< 4 µm (< 0.000157")
X-LRT0250HL-BE08C	0.390625 µm	250 mm (9.843")	113 µm (0.004449")	< 4 µm (< 0.000157")
X-LRT0500AL-E08C	0.124023438 µm	500 mm (19.685")	125 µm (0.004921")	< 4 µm (< 0.000157")
X-LRT0500BL-E08C	0.49609375 µm	500 mm (19.685")	125 µm (0.004921")	< 4 µm (< 0.000157")
X-LRT0500BL-BE08C	0.49609375 µm	500 mm (19.685")	125 µm (0.004921")	< 4 µm (< 0.000157")
X-LRT0500DL-E08C	1.984375 µm	500 mm (19.685")	125 µm (0.004921")	< 8 µm (< 0.000315")
		500 mm	125 µm	< 8 µm

Part Number	Microstep Size (Default Resolution)	Travel Range	Accuracy (unidirectional)	Repeatability
X-LRT0500DL-BE08C	1.984375 µm	(19.685")	(0.004921")	(< 0.000315")
X-LRT0500HL-E08C	0.390625 µm	500 mm (19.685")	225 µm (0.008858")	< 4 µm (< 0.000157")
X-LRT0500HL-BE08C	0.390625 µm	500 mm (19.685")	225 µm (0.008858")	< 4 µm (< 0.000157")
X-LRT0750AL-E08C	0.124023438 µm	750 mm (29.528")	188 µm (0.007402")	< 4 µm (< 0.000157")
X-LRT0750BL-E08C	0.49609375 µm	750 mm (29.528")	188 µm (0.007402")	< 4 µm (< 0.000157")
X-LRT0750BL-BE08C	0.49609375 µm	750 mm (29.528")	188 µm (0.007402")	< 4 µm (< 0.000157")
X-LRT0750DL-E08C	1.984375 µm	750 mm (29.528")	188 µm (0.007402")	< 8 µm (< 0.000315")
X-LRT0750DL-BE08C	1.984375 µm	750 mm (29.528")	188 µm (0.007402")	< 8 µm (< 0.000315")
X-LRT0750HL-E08C	0.390625 µm	750 mm (29.528")	338 µm (0.013307")	< 4 µm (< 0.000157")
X-LRT0750HL-BE08C	0.390625 µm	750 mm (29.528")	338 µm (0.013307")	< 4 µm (< 0.000157")
X-LRT1000AL-E08C	0.124023438 µm	1000 mm (39.370")	250 µm (0.009842")	< 4 µm (< 0.000157")
X-LRT1000BL-E08C	0.49609375 µm	1000 mm (39.370")	250 µm (0.009842")	< 4 µm (< 0.000157")
X-LRT1000BL-BE08C	0.49609375 µm	1000 mm (39.370")	250 µm (0.009842")	< 4 µm (< 0.000157")
X-LRT1000DL-E08C	1.984375 µm	1000 mm (39.370")	250 µm (0.009842")	< 8 µm (< 0.000315")
X-LRT1000DL-BE08C	1.984375 µm	1000 mm (39.370")	250 µm (0.009842")	< 8 µm (< 0.000315")
X-LRT1000HL-E08C	0.390625 µm	1000 mm (39.370")	450 µm (0.017716")	< 4 µm (< 0.000157")
X-LRT1000HL-BE08C	0.390625 µm	1000 mm (39.370")	450 µm (0.017716")	< 4 µm (< 0.000157")
X-LRT1500AL-E08C	0.124023438 µm	1500 mm (59.055")	375 µm (0.014764")	< 4 µm (< 0.000157")
X-LRT1500BL-E08C	0.49609375 µm	1500 mm (59.055")	375 µm (0.014764")	< 4 µm (< 0.000157")
X-LRT1500BL-BE08C	0.49609375 µm	1500 mm (59.055")	375 µm (0.014764")	< 4 µm (< 0.000157")
X-LRT1500DL-E08C	1.984375 µm	1500 mm (59.055")	375 µm (0.014764")	< 8 µm (< 0.000315")

Part Number	Microstep Size (Default Resolution)	Travel Range	Accuracy (unidirectional)	Repeatability
-------------	-------------------------------------	--------------	---------------------------	---------------

X-LRT1500DL-BE08C	1.984375 µm	1500 mm (59.055")	375 µm (0.014764")	< 8 µm (< 0.000315")
-------------------	-------------	-------------------	--------------------	----------------------

Part Number	Backlash	Maximum Speed	Minimum Speed	Speed Resolution
-------------	----------	---------------	---------------	------------------

X-LRT0100AL-E08C	< 12 µm (< 0.000472")	45 mm/s (1.772"/s)	0.000076 mm/s (0.000003"/s)	0.000076 mm/s (0.000003"/s)
------------------	-----------------------	--------------------	-----------------------------	-----------------------------

X-LRT0100BL-E08C	< 45 µm (< 0.001772")	175 mm/s (6.890"/s)	0.000303 mm/s (0.000012"/s)	0.000303 mm/s (0.000012"/s)
------------------	-----------------------	---------------------	-----------------------------	-----------------------------

X-LRT0100BL-BE08C	< 45 µm (< 0.001772")	175 mm/s (6.890"/s)	0.000303 mm/s (0.000012"/s)	0.000303 mm/s (0.000012"/s)
-------------------	-----------------------	---------------------	-----------------------------	-----------------------------

X-LRT0100DL-E08C	< 75 µm (< 0.002953")	700 mm/s (27.559"/s)	0.001212 mm/s (0.000048"/s)	0.001212 mm/s (0.000048"/s)
------------------	-----------------------	----------------------	-----------------------------	-----------------------------

X-LRT0100DL-BE08C	< 75 µm (< 0.002953")	700 mm/s (27.559"/s)	0.001212 mm/s (0.000048"/s)	0.001212 mm/s (0.000048"/s)
-------------------	-----------------------	----------------------	-----------------------------	-----------------------------

X-LRT0100HL-E08C	< 25 µm (< 0.000984")	240 mm/s (9.449"/s)	0.000239 mm/s (0.000009"/s)	0.000239 mm/s (0.000009"/s)
------------------	-----------------------	---------------------	-----------------------------	-----------------------------

X-LRT0100HL-BE08C	< 25 µm (< 0.000984")	240 mm/s (9.449"/s)	0.000239 mm/s (0.000009"/s)	0.000239 mm/s (0.000009"/s)
-------------------	-----------------------	---------------------	-----------------------------	-----------------------------

X-LRT0250AL-E08C	< 12 µm (< 0.000472")	45 mm/s (1.772"/s)	0.000076 mm/s (0.000003"/s)	0.000076 mm/s (0.000003"/s)
------------------	-----------------------	--------------------	-----------------------------	-----------------------------

X-LRT0250BL-E08C	< 45 µm (< 0.001772")	175 mm/s (6.890"/s)	0.000303 mm/s (0.000012"/s)	0.000303 mm/s (0.000012"/s)
------------------	-----------------------	---------------------	-----------------------------	-----------------------------

X-LRT0250BL-BE08C	< 45 µm (< 0.001772")	175 mm/s (6.890"/s)	0.000303 mm/s (0.000012"/s)	0.000303 mm/s (0.000012"/s)
-------------------	-----------------------	---------------------	-----------------------------	-----------------------------

X-LRT0250DL-E08C	< 75 µm (< 0.002953")	700 mm/s (27.559"/s)	0.001212 mm/s (0.000048"/s)	0.001212 mm/s (0.000048"/s)
------------------	-----------------------	----------------------	-----------------------------	-----------------------------

X-LRT0250DL-BE08C	< 75 µm (< 0.002953")	700 mm/s (27.559"/s)	0.001212 mm/s (0.000048"/s)	0.001212 mm/s (0.000048"/s)
-------------------	-----------------------	----------------------	-----------------------------	-----------------------------

X-LRT0250HL-E08C	< 25 µm (< 0.000984")	240 mm/s (9.449"/s)	0.000239 mm/s (0.000009"/s)	0.000239 mm/s (0.000009"/s)
------------------	-----------------------	---------------------	-----------------------------	-----------------------------

X-LRT0250HL-BE08C	< 25 µm (< 0.000984")	240 mm/s (9.449"/s)	0.000239 mm/s (0.000009"/s)	0.000239 mm/s (0.000009"/s)
-------------------	-----------------------	---------------------	-----------------------------	-----------------------------

X-LRT0500AL-E08C	< 12 µm (< 0.000472")	45 mm/s (1.772"/s)	0.000076 mm/s (0.000003"/s)	0.000076 mm/s (0.000003"/s)
------------------	-----------------------	--------------------	-----------------------------	-----------------------------

X-LRT0500BL-E08C	< 45 µm (< 0.001772")	175 mm/s (6.890"/s)	0.000303 mm/s (0.000012"/s)	0.000303 mm/s (0.000012"/s)
------------------	-----------------------	---------------------	-----------------------------	-----------------------------

X-LRT0500BL-BE08C	< 45 µm (< 0.001772")	175 mm/s (6.890"/s)	0.000303 mm/s (0.000012"/s)	0.000303 mm/s (0.000012"/s)
-------------------	-----------------------	---------------------	-----------------------------	-----------------------------

X-LRT0500DL-E08C	< 75 µm (< 0.002953")	700 mm/s (27.559"/s)	0.001212 mm/s (0.000048"/s)	0.001212 mm/s (0.000048"/s)
------------------	-----------------------	----------------------	-----------------------------	-----------------------------

	< 75 µm	700 mm/s	0.001212 mm/s	0.001212 mm/s
--	---------	----------	---------------	---------------

Part Number	Backlash	Maximum Speed	Minimum Speed	Speed Resolution
X-LRT0500DL-BE08C	(< 0.002953")	(27.559"/s)	(0.000048"/s)	(0.000048"/s)
X-LRT0500HL-E08C	< 25 µm (< 0.000984")	240 mm/s (9.449"/s)	0.000239 mm/s (0.000009"/s)	0.000239 mm/s (0.000009"/s)
X-LRT0500HL-BE08C	< 25 µm (< 0.000984")	240 mm/s (9.449"/s)	0.000239 mm/s (0.000009"/s)	0.000239 mm/s (0.000009"/s)
X-LRT0750AL-E08C	< 12 µm (< 0.000472")	45 mm/s (1.772"/s)	0.000076 mm/s (0.000003"/s)	0.000076 mm/s (0.000003"/s)
X-LRT0750BL-E08C	< 45 µm (< 0.001772")	175 mm/s (6.890"/s)	0.000303 mm/s (0.000012"/s)	0.000303 mm/s (0.000012"/s)
X-LRT0750BL-BE08C	< 45 µm (< 0.001772")	175 mm/s (6.890"/s)	0.000303 mm/s (0.000012"/s)	0.000303 mm/s (0.000012"/s)
X-LRT0750DL-E08C	< 75 µm (< 0.002953")	700 mm/s (27.559"/s)	0.001212 mm/s (0.000048"/s)	0.001212 mm/s (0.000048"/s)
X-LRT0750DL-BE08C	< 75 µm (< 0.002953")	700 mm/s (27.559"/s)	0.001212 mm/s (0.000048"/s)	0.001212 mm/s (0.000048"/s)
X-LRT0750HL-E08C	< 25 µm (< 0.000984")	150 mm/s (5.905"/s)	0.000239 mm/s (0.000009"/s)	0.000239 mm/s (0.000009"/s)
X-LRT0750HL-BE08C	< 25 µm (< 0.000984")	150 mm/s (5.905"/s)	0.000239 mm/s (0.000009"/s)	0.000239 mm/s (0.000009"/s)
X-LRT1000AL-E08C	< 12 µm (< 0.000472")	28 mm/s (1.102"/s)	0.000076 mm/s (0.000003"/s)	0.000076 mm/s (0.000003"/s)
X-LRT1000BL-E08C	< 45 µm (< 0.001772")	120 mm/s (4.724"/s)	0.000303 mm/s (0.000012"/s)	0.000303 mm/s (0.000012"/s)
X-LRT1000BL-BE08C	< 45 µm (< 0.001772")	120 mm/s (4.724"/s)	0.000303 mm/s (0.000012"/s)	0.000303 mm/s (0.000012"/s)
X-LRT1000DL-E08C	< 75 µm (< 0.002953")	500 mm/s (19.685"/s)	0.001212 mm/s (0.000048"/s)	0.001212 mm/s (0.000048"/s)
X-LRT1000DL-BE08C	< 75 µm (< 0.002953")	500 mm/s (19.685"/s)	0.001212 mm/s (0.000048"/s)	0.001212 mm/s (0.000048"/s)
X-LRT1000HL-E08C	< 25 µm (< 0.000984")	95 mm/s (3.740"/s)	0.000239 mm/s (0.000009"/s)	0.000239 mm/s (0.000009"/s)
X-LRT1000HL-BE08C	< 25 µm (< 0.000984")	95 mm/s (3.740"/s)	0.000239 mm/s (0.000009"/s)	0.000239 mm/s (0.000009"/s)
X-LRT1500AL-E08C	< 12 µm (< 0.000472")	13 mm/s (0.512"/s)	0.000076 mm/s (0.000003"/s)	0.000076 mm/s (0.000003"/s)
X-LRT1500BL-E08C	< 45 µm (< 0.001772")	55 mm/s (2.165"/s)	0.000303 mm/s (0.000012"/s)	0.000303 mm/s (0.000012"/s)
X-LRT1500BL-BE08C	< 45 µm (< 0.001772")	55 mm/s (2.165"/s)	0.000303 mm/s (0.000012"/s)	0.000303 mm/s (0.000012"/s)
X-LRT1500DL-E08C	< 75 µm (< 0.002953")	225 mm/s (8.858"/s)	0.001212 mm/s (0.000048"/s)	0.001212 mm/s (0.000048"/s)
X-LRT1500DL-BE08C	< 75 µm	225 mm/s	0.001212 mm/s	0.001212 mm/s

Part Number	Backlash	Maximum Speed	Minimum Speed	Speed Resolution
	(< 0.002953")	(8.858"/s)	(0.000048"/s)	(0.000048"/s)

Part Number	Peak Thrust	Back-driving Force	Maximum Continuous Thrust	Linear Motion Per Motor Rev
X-LRT0100AL-E08C	1200 N (269.1 lb)	Non-back-driving	1200 N (269.1 lb)	1.5875 mm (0.062")
X-LRT0100BL-E08C	600 N (134.6 lb)	(± 30%) 420 N (94.2 lb)	600 N (134.6 lb)	6.35 mm (0.250")
X-LRT0100BL-BE08C	600 N (134.6 lb)	(± 30%) 420 N (94.2 lb)	600 N (134.6 lb)	6.35 mm (0.250")
X-LRT0100DL-E08C	200 N (44.9 lb)	(± 30%) 40 N (9.0 lb)	180 N (40.4 lb)	25.4 mm (1.000")
X-LRT0100DL-BE08C	200 N (44.9 lb)	(± 30%) 40 N (9.0 lb)	180 N (40.4 lb)	25.4 mm (1.000")
X-LRT0100HL-E08C	1200 N (269.1 lb)	(± 30%) 157 N (35.2 lb)	1200 N (269.1 lb)	5 mm (0.197")
X-LRT0100HL-BE08C	1200 N (269.1 lb)	(± 30%) 157 N (35.2 lb)	1200 N (269.1 lb)	5 mm (0.197")
X-LRT0250AL-E08C	1200 N (269.1 lb)	Non-back-driving	1200 N (269.1 lb)	1.5875 mm (0.062")
X-LRT0250BL-E08C	600 N (134.6 lb)	(± 30%) 420 N (94.2 lb)	600 N (134.6 lb)	6.35 mm (0.250")
X-LRT0250BL-BE08C	600 N (134.6 lb)	(± 30%) 420 N (94.2 lb)	600 N (134.6 lb)	6.35 mm (0.250")
X-LRT0250DL-E08C	200 N (44.9 lb)	(± 30%) 40 N (9.0 lb)	180 N (40.4 lb)	25.4 mm (1.000")
X-LRT0250DL-BE08C	200 N (44.9 lb)	(± 30%) 40 N (9.0 lb)	180 N (40.4 lb)	25.4 mm (1.000")
X-LRT0250HL-E08C	1200 N (269.1 lb)	(± 30%) 157 N (35.2 lb)	1200 N (269.1 lb)	5 mm (0.197")
X-LRT0250HL-BE08C	1200 N (269.1 lb)	(± 30%) 157 N (35.2 lb)	1200 N (269.1 lb)	5 mm (0.197")
X-LRT0500AL-E08C	1200 N (269.1 lb)	Non-back-driving	1200 N (269.1 lb)	1.5875 mm (0.062")
X-LRT0500BL-E08C	600 N (134.6 lb)	(± 30%) 420 N (94.2 lb)	600 N (134.6 lb)	6.35 mm (0.250")
X-LRT0500BL-BE08C	600 N (134.6 lb)	(± 30%) 420 N (94.2 lb)	600 N (134.6 lb)	6.35 mm (0.250")
X-LRT0500DL-E08C	200 N (44.9 lb)	(± 30%) 40 N (9.0 lb)	180 N (40.4 lb)	25.4 mm (1.000")

Part Number	Peak Thrust	Back-driving Force	Maximum Continuous Thrust	Linear Motion Per Motor Rev
X-LRT0500DL-BE08C	200 N (44.9 lb)	(± 30%) 40 N (9.0 lb)	180 N (40.4 lb)	25.4 mm (1.000")
X-LRT0500HL-E08C	1200 N (269.1 lb)	(± 30%) 157 N (35.2 lb)	1200 N (269.1 lb)	5 mm (0.197")
X-LRT0500HL-BE08C	1200 N (269.1 lb)	(± 30%) 157 N (35.2 lb)	1200 N (269.1 lb)	5 mm (0.197")
X-LRT0750AL-E08C	1200 N (269.1 lb)	Non-back-driving	1200 N (269.1 lb)	1.5875 mm (0.062")
X-LRT0750BL-E08C	600 N (134.6 lb)	(± 30%) 420 N (94.2 lb)	600 N (134.6 lb)	6.35 mm (0.250")
X-LRT0750BL-BE08C	600 N (134.6 lb)	(± 30%) 420 N (94.2 lb)	600 N (134.6 lb)	6.35 mm (0.250")
X-LRT0750DL-E08C	200 N (44.9 lb)	(± 30%) 40 N (9.0 lb)	180 N (40.4 lb)	25.4 mm (1.000")
X-LRT0750DL-BE08C	200 N (44.9 lb)	(± 30%) 40 N (9.0 lb)	180 N (40.4 lb)	25.4 mm (1.000")
X-LRT0750HL-E08C	1200 N (269.1 lb)	(± 30%) 157 N (35.2 lb)	1200 N (269.1 lb)	5 mm (0.197")
X-LRT0750HL-BE08C	1200 N (269.1 lb)	(± 30%) 157 N (35.2 lb)	1200 N (269.1 lb)	5 mm (0.197")
X-LRT1000AL-E08C	1200 N (269.1 lb)	Non-back-driving	1200 N (269.1 lb)	1.5875 mm (0.062")
X-LRT1000BL-E08C	600 N (134.6 lb)	(± 30%) 420 N (94.2 lb)	600 N (134.6 lb)	6.35 mm (0.250")
X-LRT1000BL-BE08C	600 N (134.6 lb)	(± 30%) 420 N (94.2 lb)	600 N (134.6 lb)	6.35 mm (0.250")
X-LRT1000DL-E08C	200 N (44.9 lb)	(± 30%) 40 N (9.0 lb)	180 N (40.4 lb)	25.4 mm (1.000")
X-LRT1000DL-BE08C	200 N (44.9 lb)	(± 30%) 40 N (9.0 lb)	180 N (40.4 lb)	25.4 mm (1.000")
X-LRT1000HL-E08C	1200 N (269.1 lb)	(± 30%) 157 N (35.2 lb)	1200 N (269.1 lb)	5 mm (0.197")
X-LRT1000HL-BE08C	1200 N (269.1 lb)	(± 30%) 157 N (35.2 lb)	1200 N (269.1 lb)	5 mm (0.197")
X-LRT1500AL-E08C	1200 N (269.1 lb)	Non-back-driving	1200 N (269.1 lb)	1.5875 mm (0.062")
X-LRT1500BL-E08C	600 N (134.6 lb)	(± 30%) 420 N (94.2 lb)	600 N (134.6 lb)	6.35 mm (0.250")
X-LRT1500BL-BE08C	600 N (134.6 lb)	(± 30%) 420 N (94.2 lb)	600 N (134.6 lb)	6.35 mm (0.250")
X-LRT1500DL-E08C	200 N (44.9 lb)	(± 30%) 40 N (9.0 lb)	180 N (40.4 lb)	25.4 mm (1.000")

(± 30%) 40 N

Part Number	Peak Thrust	Back-driving Force	Maximum Continuous Thrust	Linear Motion Per Motor Rev
X-LRT1500DL-BE08C	200 N (44.9 lb)	(9.0 lb)	180 N (40.4 lb)	25.4 mm (1.000")

Part Number	Mechanical Drive System	Maximum Axial Brake Force	Weight
X-LRT0100AL-E08C	Precision lead screw		3.65 kg (8.047 lb)
X-LRT0100BL-E08C	Precision lead screw		3.65 kg (8.047 lb)
X-LRT0100BL-BE08C	Precision lead screw	600 N (134.9 lb)	4.276 kg (9.427 lb)
X-LRT0100DL-E08C	Precision lead screw		3.65 kg (8.047 lb)
X-LRT0100DL-BE08C	Precision lead screw	180 N (40.5 lb)	4.276 kg (9.427 lb)
X-LRT0100HL-E08C	Precision ball screw		3.65 kg (8.047 lb)
X-LRT0100HL-BE08C	Precision ball screw	1200 N (269.8 lb)	4.276 kg (9.427 lb)
X-LRT0250AL-E08C	Precision lead screw		4.441 kg (9.791 lb)
X-LRT0250BL-E08C	Precision lead screw		4.441 kg (9.791 lb)
X-LRT0250BL-BE08C	Precision lead screw	600 N (134.9 lb)	5.067 kg (11.171 lb)
X-LRT0250DL-E08C	Precision lead screw		4.441 kg (9.791 lb)
X-LRT0250DL-BE08C	Precision lead screw	180 N (40.5 lb)	5.067 kg (11.171 lb)
X-LRT0250HL-E08C	Precision ball screw		4.441 kg (9.791 lb)
X-LRT0250HL-BE08C	Precision ball screw	1200 N (269.8 lb)	5.067 kg (11.171 lb)
X-LRT0500AL-E08C	Precision lead screw		5.758 kg (12.694 lb)
X-LRT0500BL-E08C	Precision lead screw		5.758 kg (12.694 lb)
X-LRT0500BL-BE08C	Precision lead screw	600 N (134.9 lb)	6.384 kg (14.074 lb)
X-LRT0500DL-E08C	Precision lead screw		5.758 kg (12.694 lb)
X-LRT0500DL-BE08C	Precision lead screw	180 N (40.5 lb)	6.384 kg (14.074 lb)
X-LRT0500HL-E08C	Precision ball screw		5.758 kg (12.694 lb)
X-LRT0500HL-BE08C	Precision ball screw	1200 N (269.8 lb)	6.384 kg (14.074 lb)
X-LRT0750AL-E08C	Precision lead screw		7.076 kg (15.600 lb)
X-LRT0750BL-E08C	Precision lead screw		7.076 kg (15.600 lb)
X-LRT0750BL-BE08C	Precision lead screw	600 N (134.9 lb)	7.702 kg (16.980 lb)
X-LRT0750DL-E08C	Precision lead screw		7.076 kg (15.600 lb)
X-LRT0750DL-BE08C	Precision lead screw	180 N (40.5 lb)	7.702 kg (16.980 lb)
X-LRT0750HL-E08C	Precision ball screw		7.076 kg (15.600 lb)
X-LRT0750HL-BE08C	Precision ball screw	1200 N (269.8 lb)	7.702 kg (16.980 lb)
X-LRT1000AL-E08C	Precision lead screw		8.393 kg (18.503 lb)

Part Number	Mechanical Drive System	Maximum Axial Brake Force	Weight
X-LRT1000BL-E08C	Precision lead screw		8.393 kg (18.503 lb)
X-LRT1000BL-BE08C	Precision lead screw	600 N (134.9 lb)	9.019 kg (19.883 lb)
X-LRT1000DL-E08C	Precision lead screw		8.393 kg (18.503 lb)
X-LRT1000DL-BE08C	Precision lead screw	180 N (40.5 lb)	9.019 kg (19.883 lb)
X-LRT1000HL-E08C	Precision ball screw		8.393 kg (18.503 lb)
X-LRT1000HL-BE08C	Precision ball screw	1200 N (269.8 lb)	9.019 kg (19.883 lb)
X-LRT1500AL-E08C	Precision lead screw		11.028 kg (24.313 lb)
X-LRT1500BL-E08C	Precision lead screw		11.028 kg (24.313 lb)
X-LRT1500BL-BE08C	Precision lead screw	600 N (134.9 lb)	11.654 kg (25.693 lb)
X-LRT1500DL-E08C	Precision lead screw		11.028 kg (24.313 lb)
X-LRT1500DL-BE08C	Precision lead screw	180 N (40.5 lb)	11.654 kg (25.693 lb)

X-LRT-EC Series Charts

Typical Microstepping Accuracy

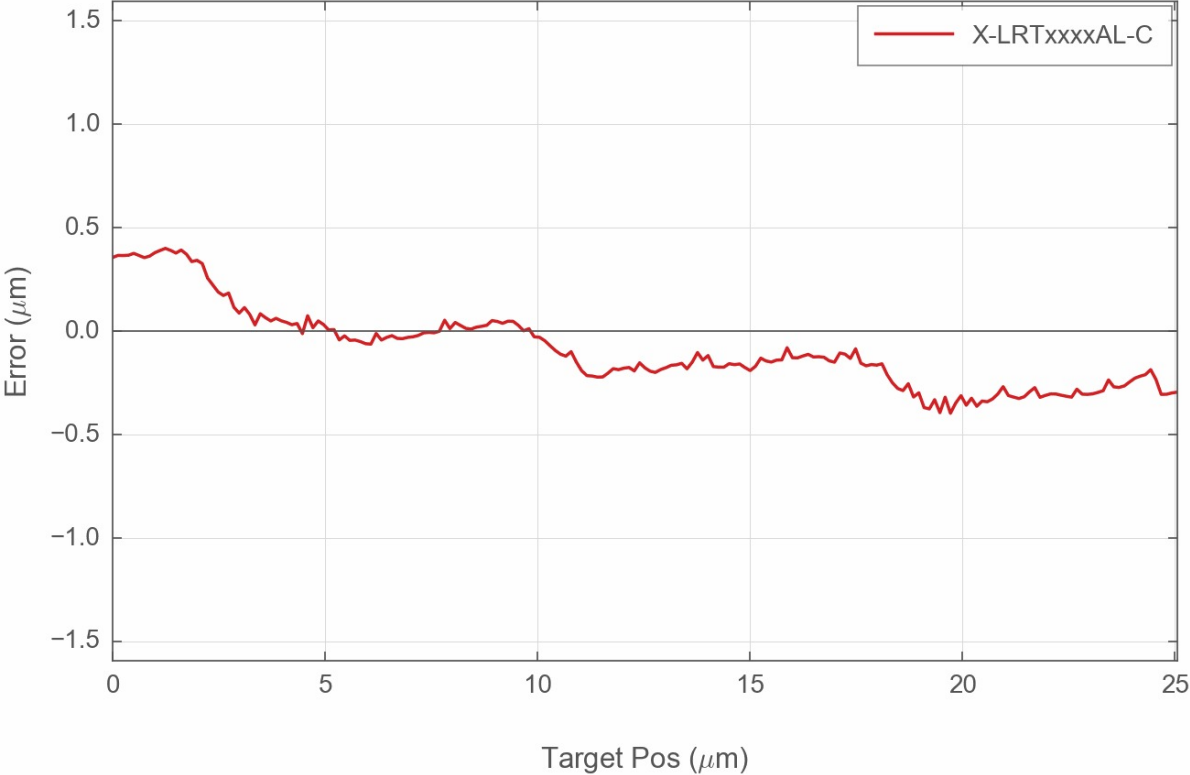

Typical Microstepping Accuracy

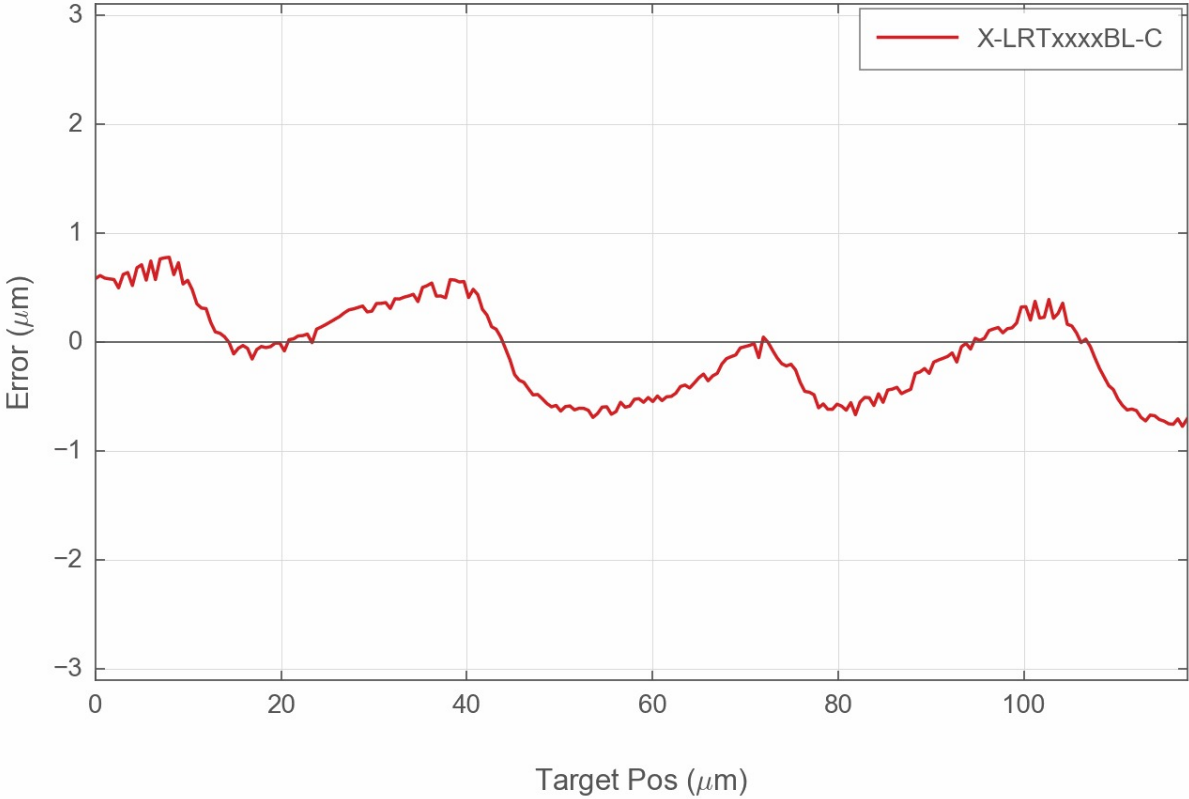

Typical Microstepping Accuracy

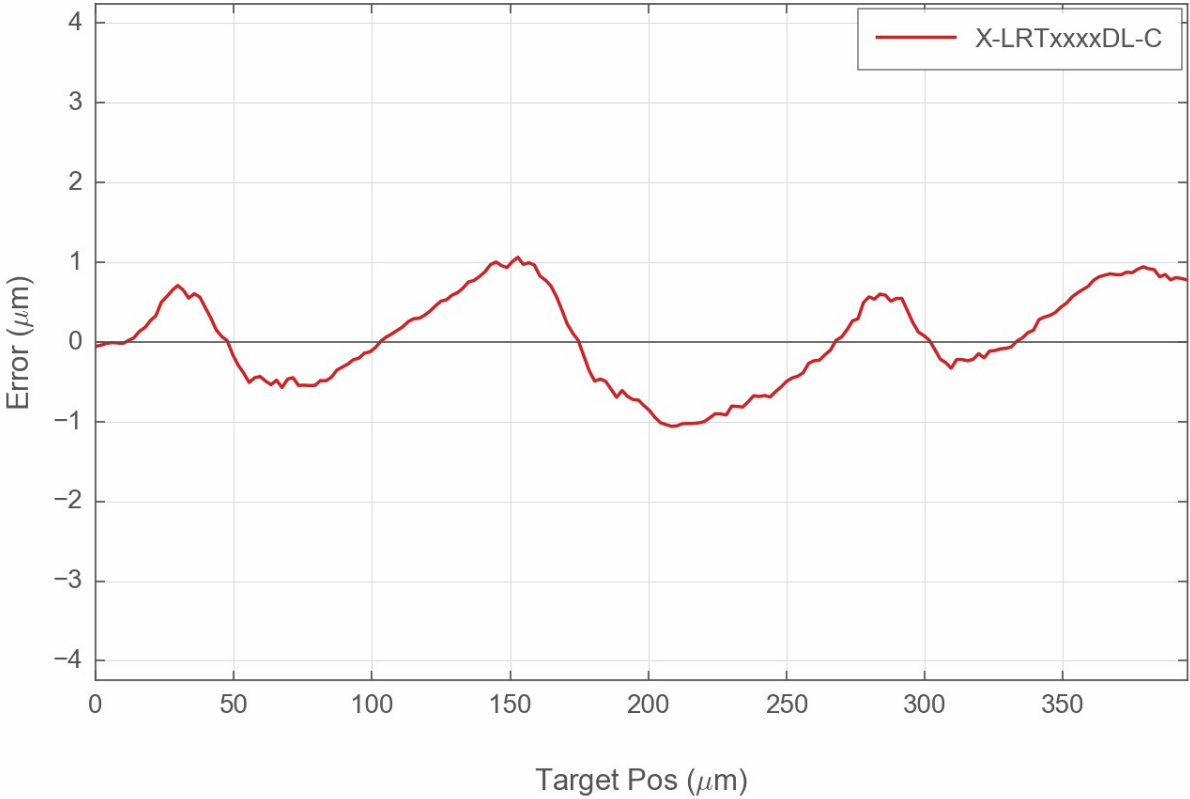

Typical Microstepping Accuracy

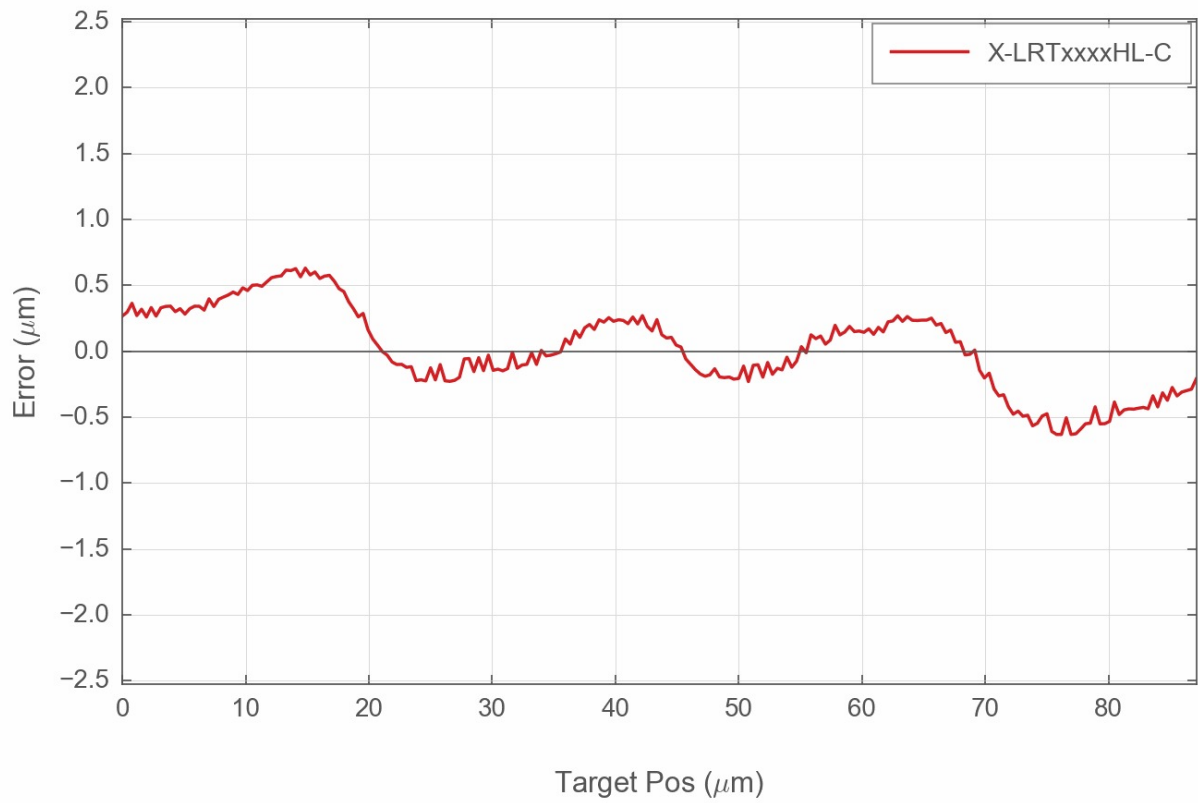

Thrust Speed Performance

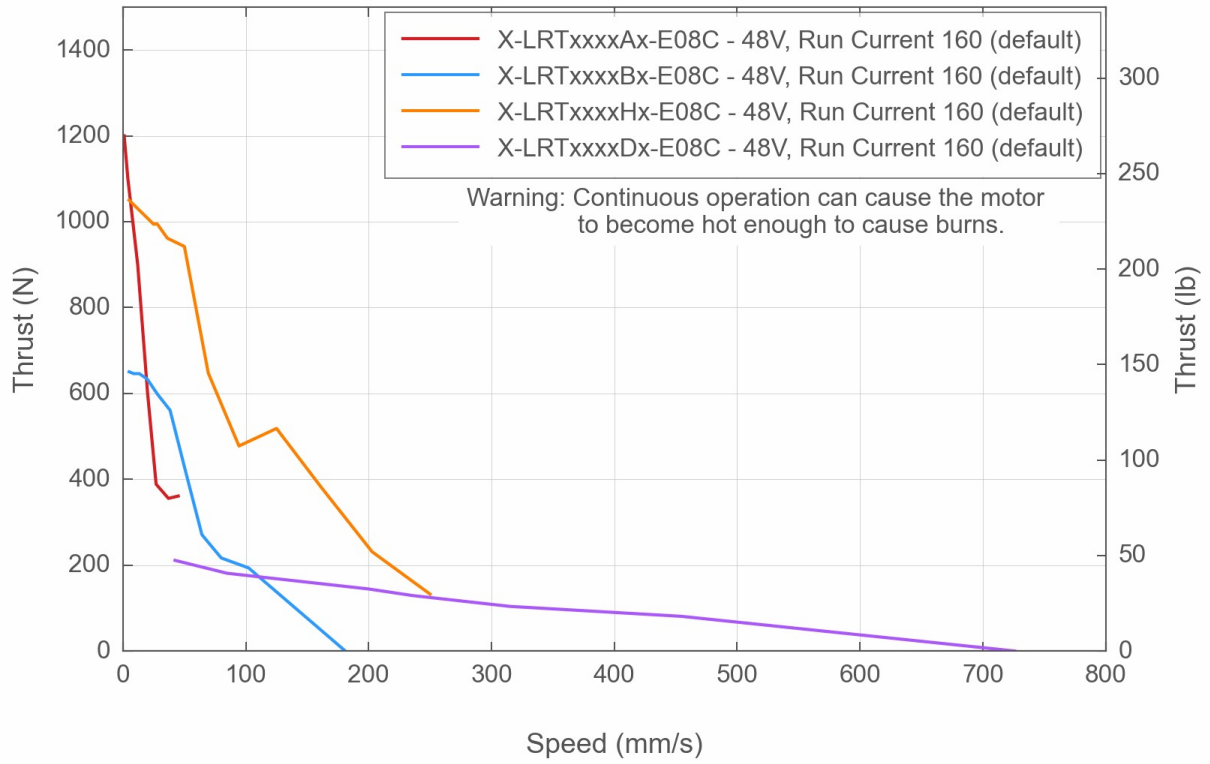

Thrust Speed Performance

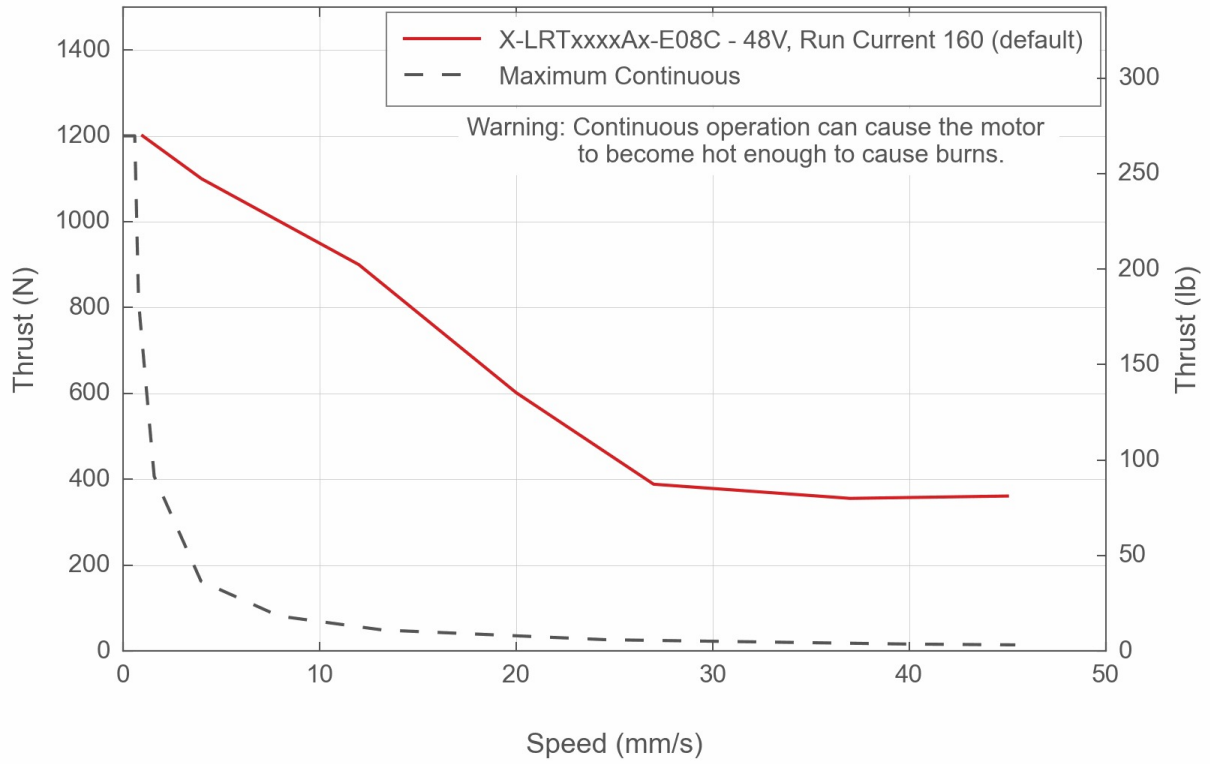

Thrust Speed Performance

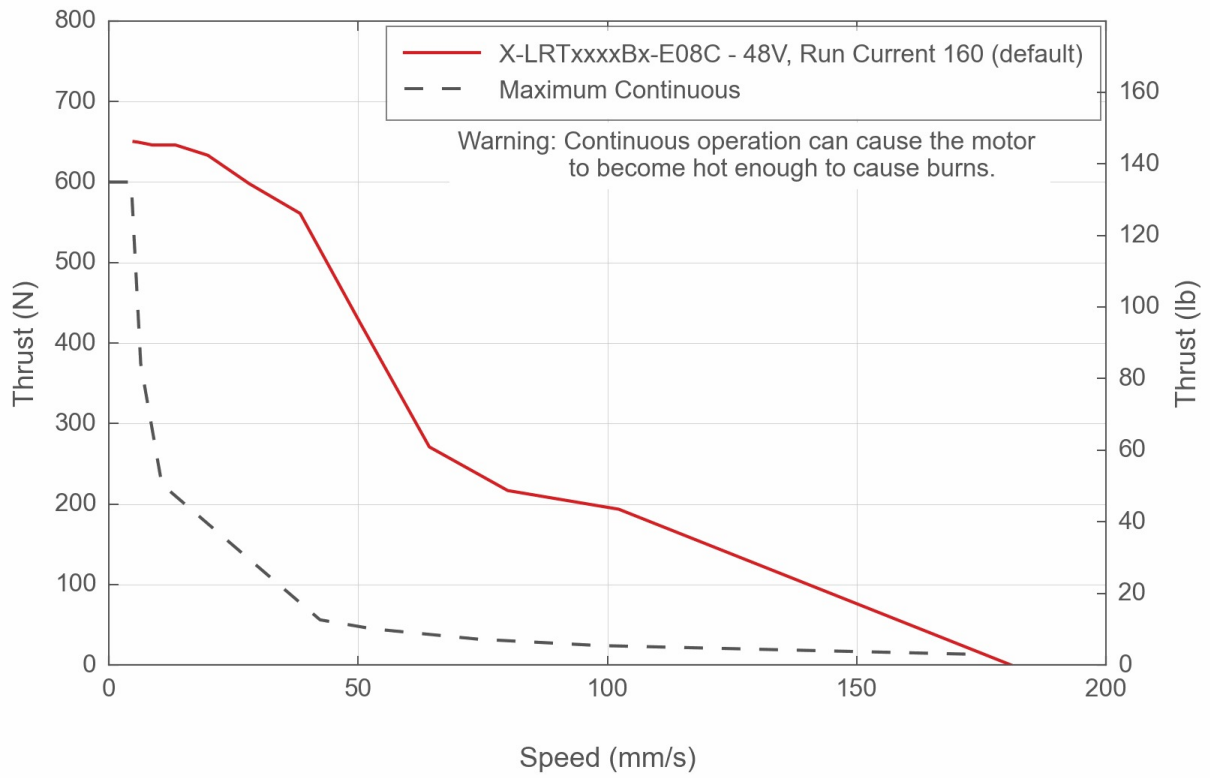

Thrust Speed Performance

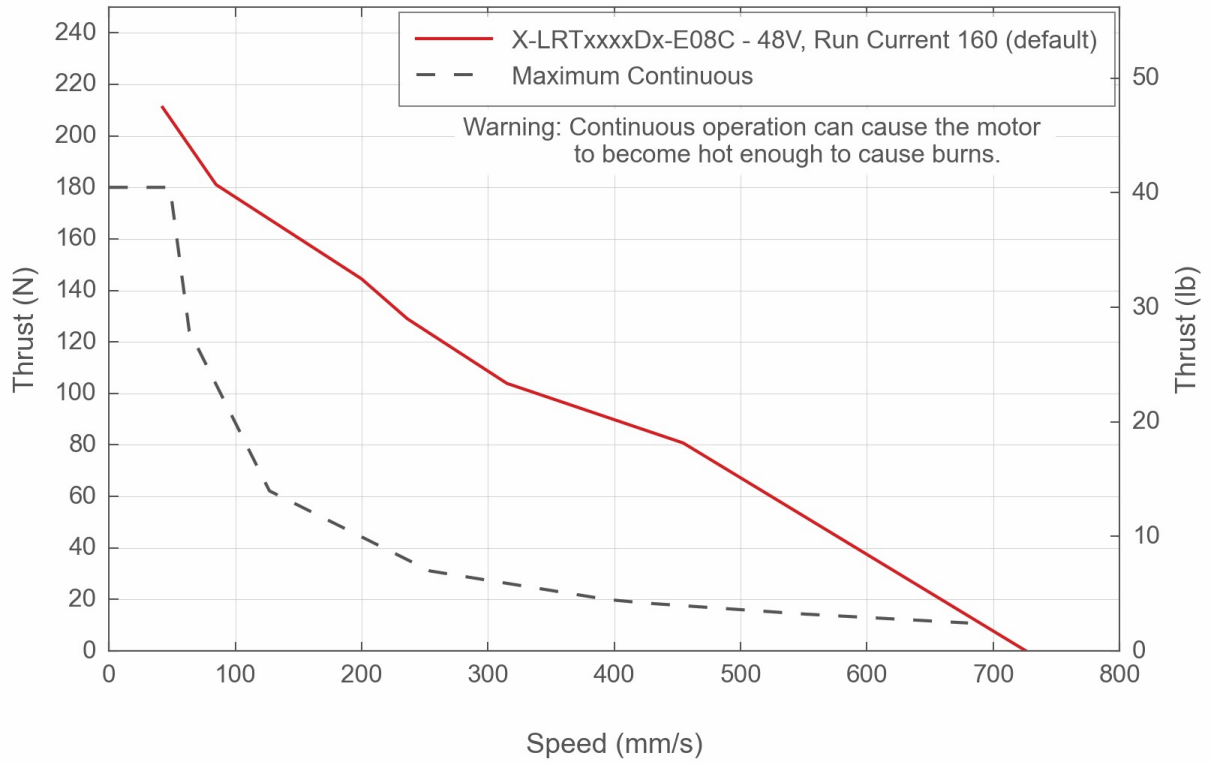

Thrust Speed Performance

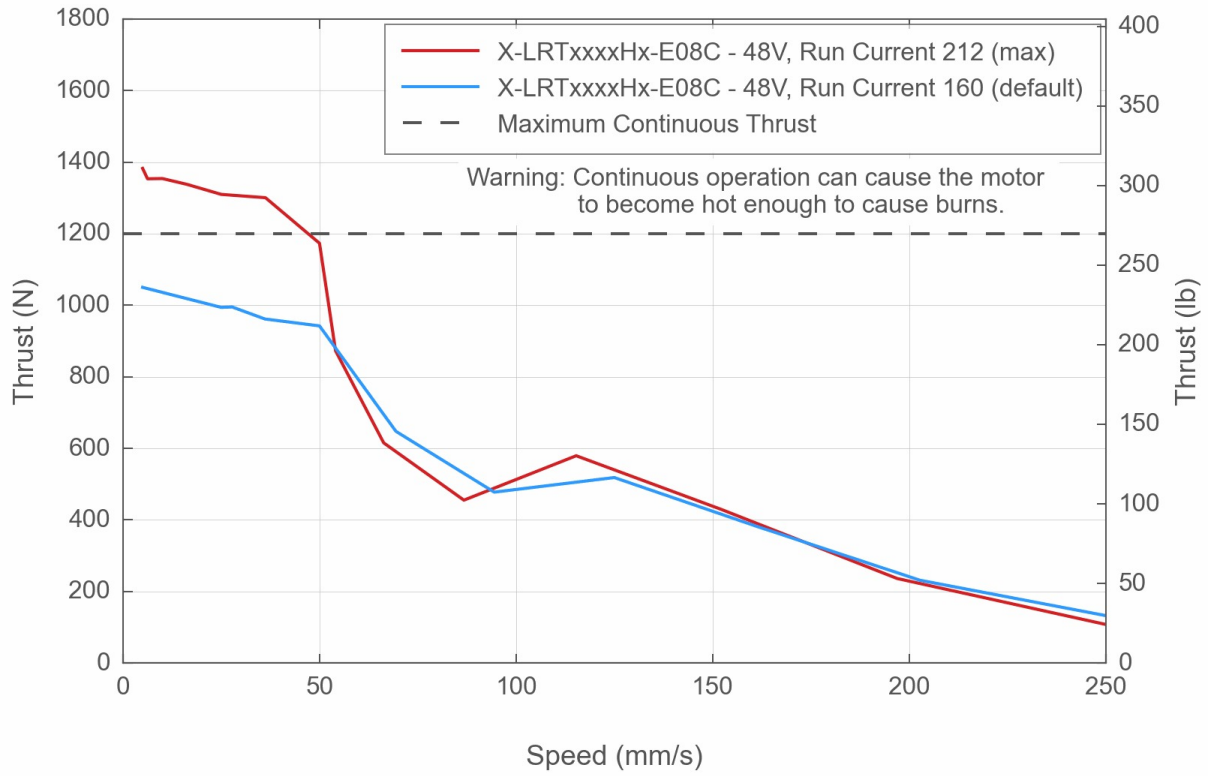

Typical LRT Bearing Lifetime

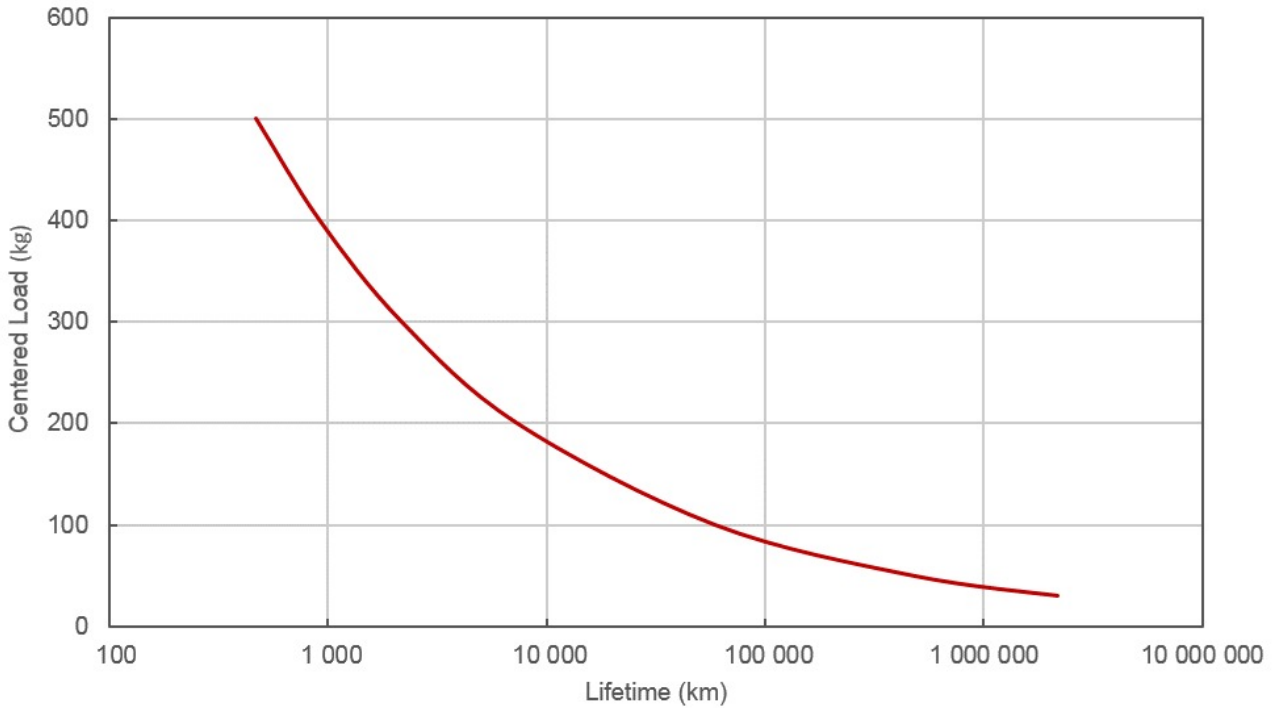

Contact

Email: contact@zaber.com

Phone (toll free Canada/USA): 1-888-276-8033

Phone (direct): 1-604-569-3780

Fax: 1-604-648-8033

Zaber Technologies Inc.

#2 - 605 West Kent Ave. N.

Vancouver, British Columbia

Canada, V6P 6T7

<https://www.zaber.com>