

- 1
- 2
- 3
- 4**
- 5
- 6
- 7
- 8
- 9
- 10
- 11
- 12
- 13
- 14
- 15
- 16
- 17
- 18

MATERIAL

Oval flat cross section aluminium, epoxy resin coating, glossy finish.

COLOUR

RAL 9002 white.

STANDARD EXECUTION

Threaded blind holes.

FEATURES AND APPLICATIONS

This handle, of white colour, is particularly suitable for applications on medical and hospital equipment and on food processing machines whose parts, for hygienic reasons, must be frequently cleaned. Its solid shape without cavities prevents unhealthy residues from depositing. Its glossy surface allows a perfect cleaning.



Conversion Table
1 mm = 0.039 inch

mm	inch
120	4.72
140	5.51
180	7.09
200	7.84
350	13.78

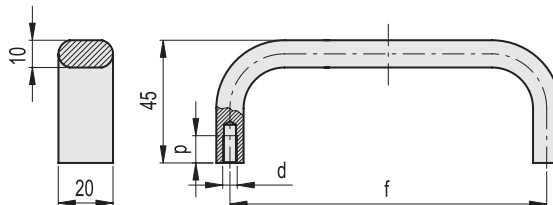

METRIC

Code	f	d	p	⚖️
RHMF-20.120.9002	120	M5	10	91
RHMF-20.140.9002	140	M5	10	99
RHMF-20.180.9002	180	M5	10	119
RHMF-20.200.9002	200	M5	10	129
RHMF-20.350.9002	350	M6	12	206

Lift & Pull handles